

# The Suffolk Specifications

Length 7,200mm | Width 2,700mm

## Main Structure

- ✓ Black plastic coated corrugated roof sheets
- ✓ Heavy duty wooden chassis
- ✓ Bespoke cast iron wheels
- ✓ Painted featheredge cladding (choice of colour)
- ✓ 240v electrics
- ✓ 80ltr hot water heater
- ✓ Mains water connection
- ✓ Mains sewage connection
- ✓ Double glazed doors and windows
- ✓ Rustic black door and window furniture
- ✓ Laminated flooring throughout (choice of colour)
- ✓ Fully decorated
- ✓ Bespoke window and door guttering

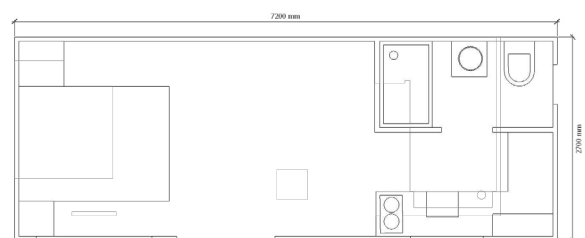
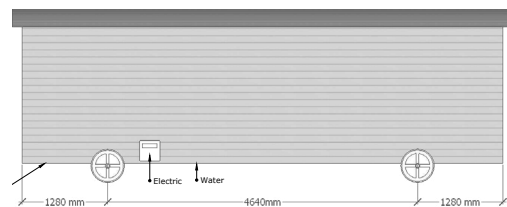
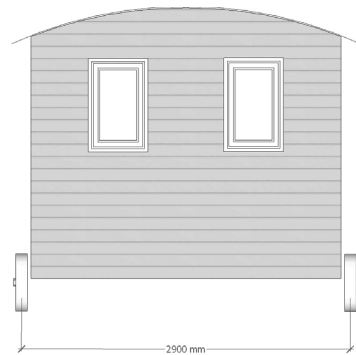

## Shower Room

- ✓ High level traditional style toilet cistern
- ✓ Ceramic wash basin with mixer tap
- ✓ Floor standing storage cabinet
- ✓ 1100mm shower with sliding door
- ✓ Traditional style exposed thermostatic shower
- ✓ Easy clean shower wall panelling (choice of design)
- ✓ Single double glazed window
- ✓ Underfloor heating

## Kitchen

- ✓ Low maintenance acrylic worktops
- ✓ Integrated fridge with ice compartment
- ✓ Built in microwave
- ✓ Range of kitchen cabinets (choice of colour)
- ✓ Ceramic butlers sink
- ✓ Traditional style mixer taps
- ✓ Wall cupboard with plate rack
- ✓ Double glazed windows to two aspects
- ✓ Underfloor heating
- ✓ 2 above counter double sockets

## Lounge

- ✓ Large open area with room for seating
- ✓ Double half glazed doors
- ✓ Lighting points
- ✓ T&G style cladding to lower wall
- ✓ Underfloor heating
- ✓ 2 double sockets
- ✓ TV socket

## Bedroom Area

- ✓ Fitted wardrobe
- ✓ Built in bed with storage below
- ✓ Bedside cabinet
- ✓ Overbed lighting points
- ✓ Large double glazed window
- ✓ Power points with USB
- ✓ Underfloor heating

